

ASSEMBLY INSTRUCTIONS HUTCH

HARDWARE

Screw 3/4"(20mm.) (2 pcs)
(Attached)



Screw Driver (Not Included)

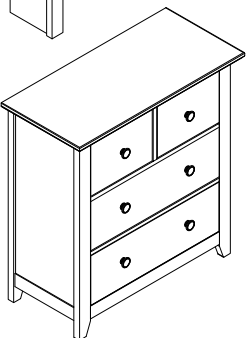
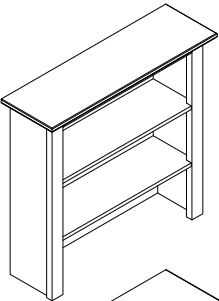
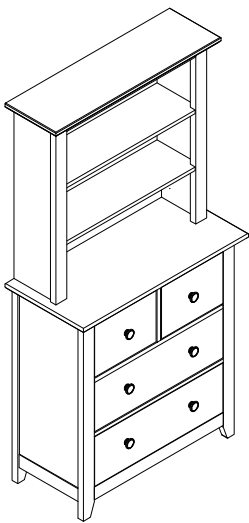
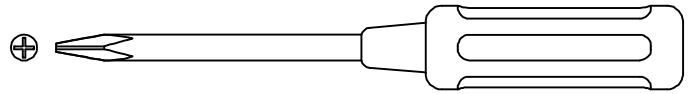

A. Put the hutch to the top of case good (example : dresser) in back side.

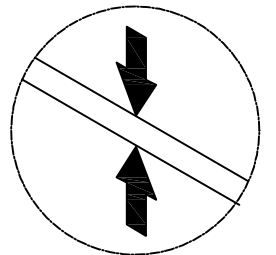
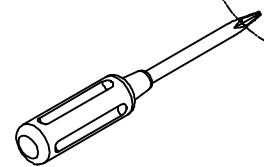
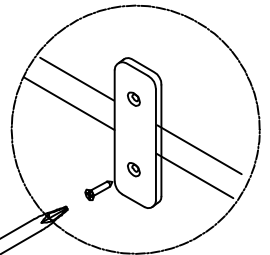
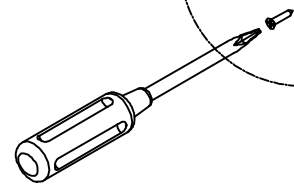
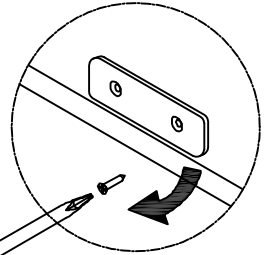
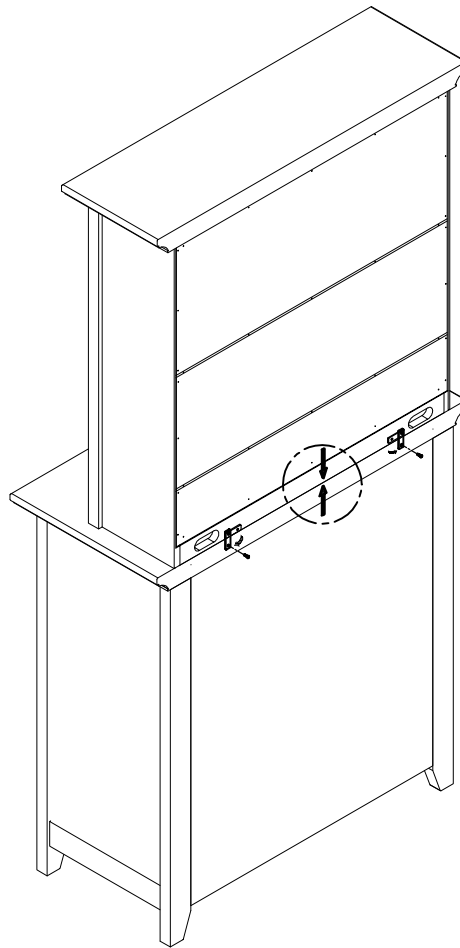

B. Metal plate already attached at HUTCH behind.
Pull out 1 screw at each metal plate,
take around to bottom side, attached again
screw & back plate to DRESSER.

RED ARROW STICKER
(ALREADY ATTACHED)



NOTE : YOU CAN APPLY YOUR HUTCH WITH
"COMBO" OR "DRESSER" OR " CHEST DRAWERS"

"THE PRODUCT IMAGES SHOWN ARE FOR ILLUSTRATION PURPOSES ONLY AND MAY NOT BE AN EXACT REPRESENTATION OF THE PRODUCT."

INSTRUCTIONS D'ASSEMBLAGE

CRÉDENCE

MATÉRIEL

Vis De 3/4" (20 mm) (2 pièces)
(Attachès)



Tour nevis (Non Inclus)

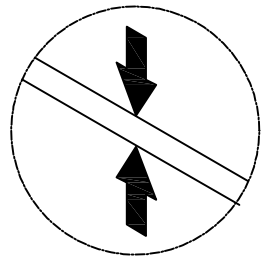
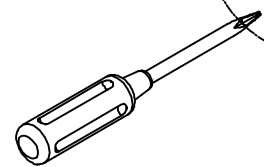
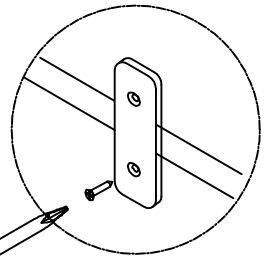
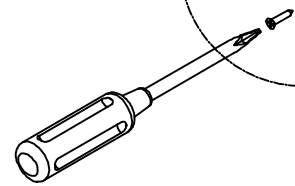
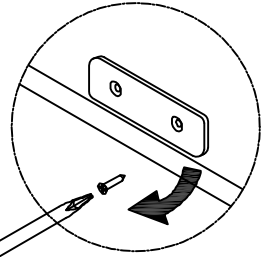
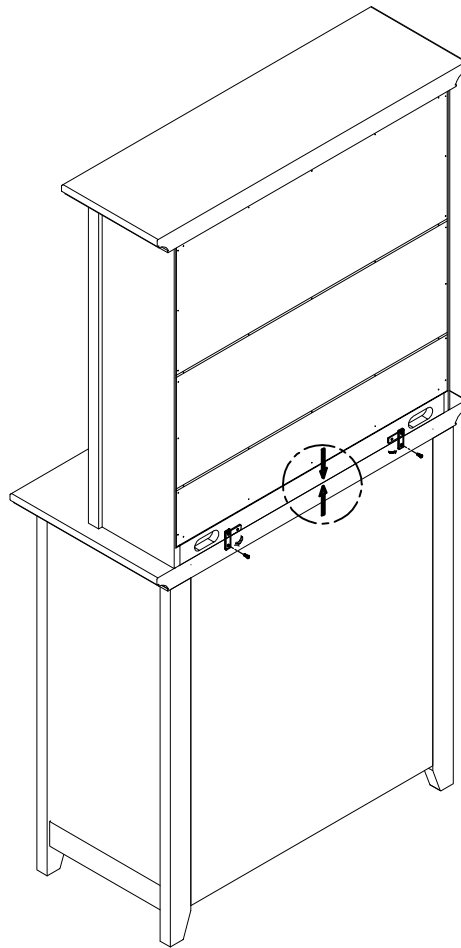
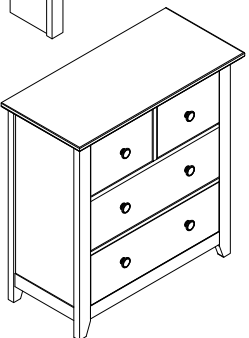
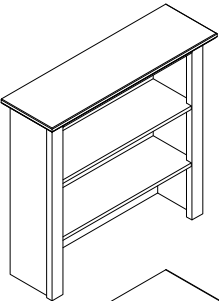
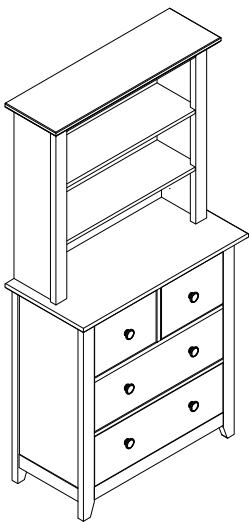
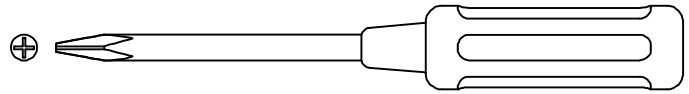

B. Plaque de métal déjà fixée au clavier derrière.
Retirer une vis à chaque plaque de métal,
prendre environ bas sur le côté, joint à nouveau
la vis et la plaque arrière à la buffet.

VIGNETTE FLÈCHE ROUGE
(DÉJA FIXÉE)

A. Mettre la cage au début de
marchandises cas (par
exemple : buffet) en arrière.



NOTE : VOUS POUVEZ APPLIQUER VOTRE
CRÉDENCE AVEC "COMBO" ou "DRESSER"
ou "TIROIR DE COMMUNE"

**"LES IMAGES DU PRODUIT PRÉSENTÉES SONT UNIQUEMENT À TITRE
D'ILLUSTRATION ET PEUVENT NE PAS ÊTRE UNE REPRÉSENTATION
EXACTE DU PRODUIT. "**